

Handout Guidance

Impervious Surfaces:

- Rooftop(s)
- Driveway(s)
- Walkway(s)
- Deck(s)
- Patio(s)
- Shed(s)

Drainage Area:

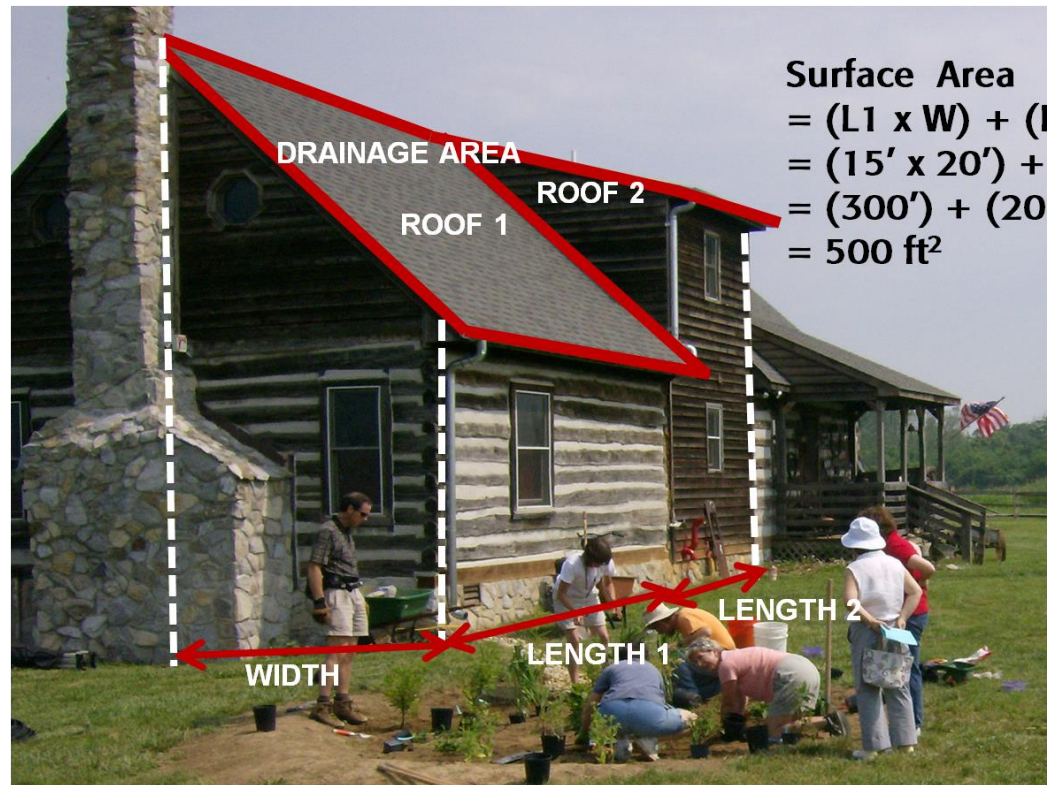

Surface Area
= (L1 x W) + (L2 x W)
= (15' x 20') + (10' x 20')
= (300') + (200')
= 500 ft²