

15'

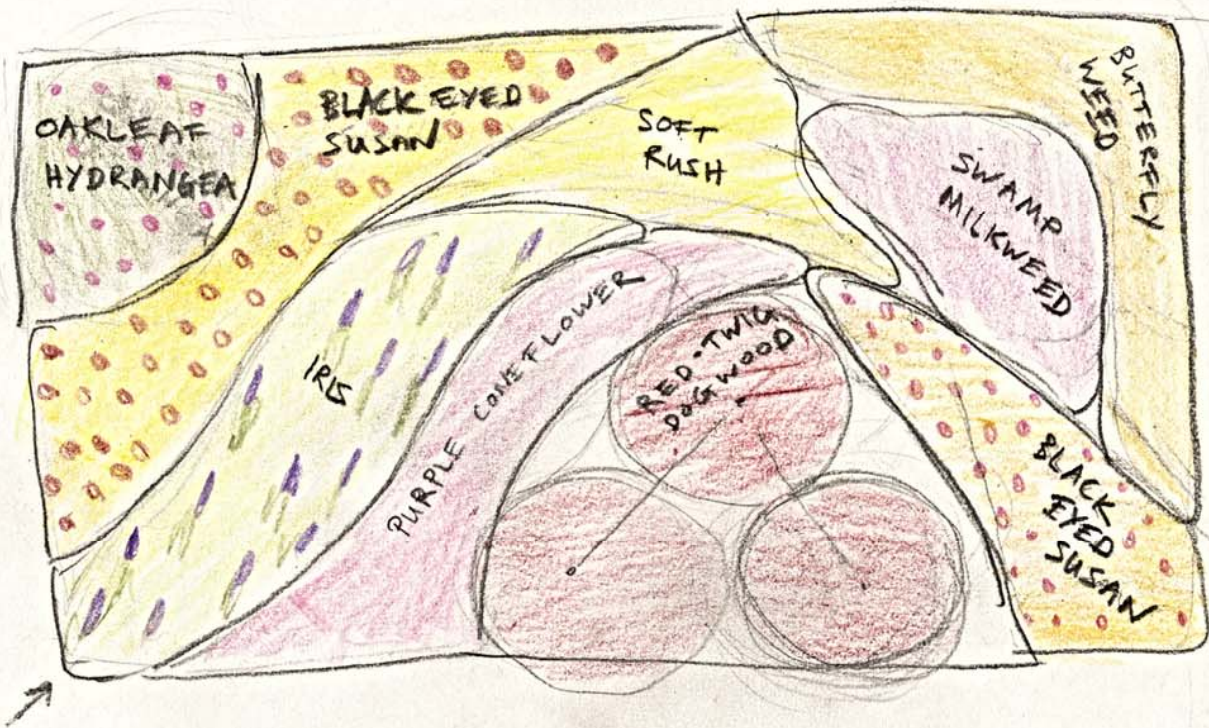

- 1 OAKLEAF HYDRANGEA
- 3 RED-TWIG DOGWOOD
- 3 SWAMP MILKWEED
- 6 BUTTERFLY WEED
- 22 BLACK EYED SUSAN
(9 + 13)
- 8 SOFT RUSH
- 9 ECHINACEA
- 15 IRIS